

Cadman

IRRIGATION & AGRICULTURAL MACHINERY



TR-MAN-6010-UG03

Upgrade - Hose Caddy Tongue Pin

Creation

20-JUL-2011
by
Ivon LeBlanc

Revision

Hose Caddy Tongue Pin

This instruction sheet will assist in the Cadman 6010 Hose Caddy tongue pin upgrade.



ONLY perform this upgrade or any other maintenance when the machine is shut down and is in a non-loaded condition. This means that no fluid is being pumped through the motor and all mechanical and hydraulic tension has been released from the hose rewind system.

Kit Contents

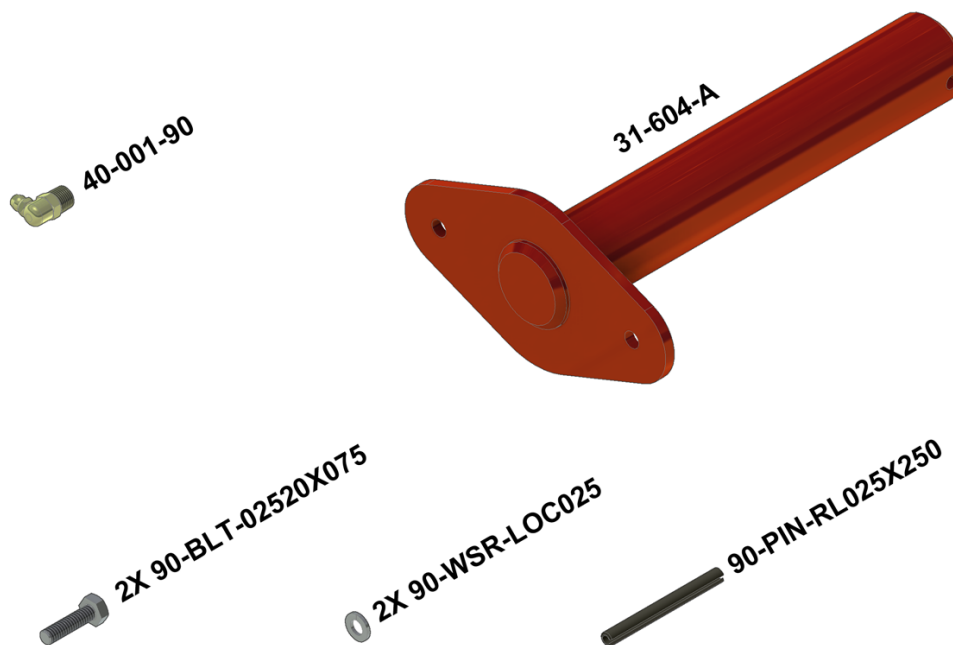

Figure 1 - Kit Contents

img-00491



Before starting this upgrade ensure that you have a complete set of required parts.

Tools Required

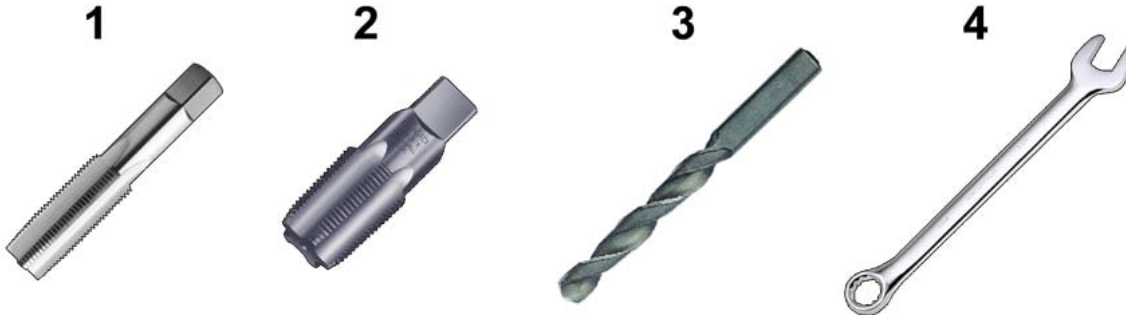

Figure 2 - Tools required

img-00492

1. 1/4"-20UNC Tap
2. 1/8"-27 NPT Tap

3. No. 7 & 11/32" Drill Bit
4. 7/16" Wrench

Complete the following instructions to upgrade your machine.

Step 1

Relieve tension on the current tongue pin by raising the front of the machine. Support the frame using appropriate supporting devices (*i.e. jack stands*).

Step 2

Remove the tongue brace pin and swing the brace and secure out of the way.

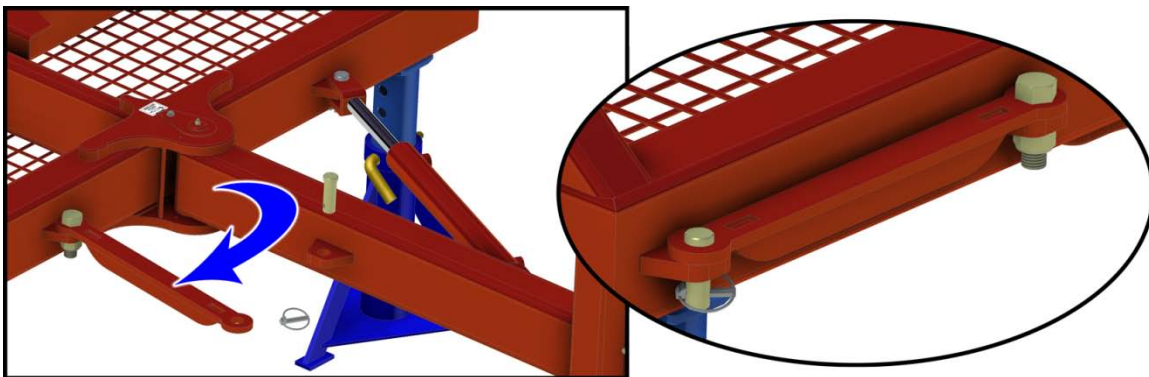

Figure 3 - Remove Tongue Brace

img-00493

Step 3

Remove the cylinder pin located on the frame and swing the cylinder away. Secure the cylinder to the tongue to prevent injuries.

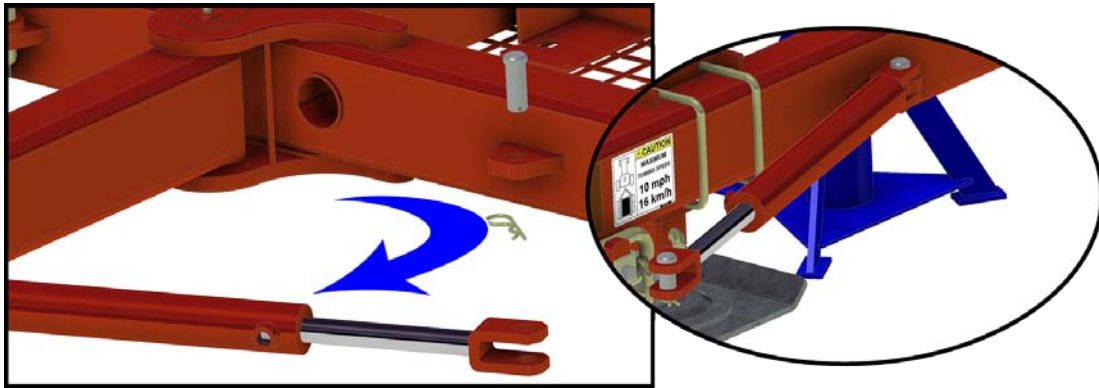

Figure 4 - Remove Cylinder

img-00494

Step 4

Swing the tongue to the right (*towards motor side*). Properly support the tongue using appropriate supporting devices (*i.e. jack stands*).



Failure to properly support the tongue may result in serious injury to you and/or spectators.

Step 5

Remove the bolt fastening the tongue pin. Then remove the pin. This may require significant force if the tension has not been relieved.

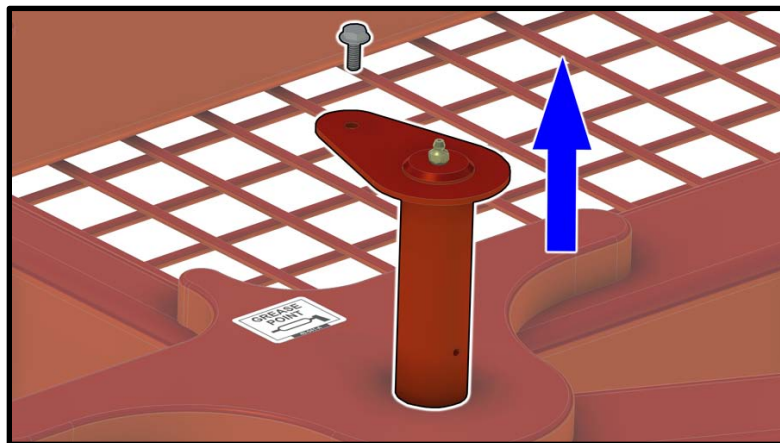

Figure 5 - Remove Tongue Pin

img-00495

Step 6

Using your 11/32" drill bit, drill a hole midway down the tongue pivot tube. Then use your 1/8"-27 NPT tapping tool. Ensure that all metal shavings are thoroughly removed. Install the provided 90 degree grease fitting.

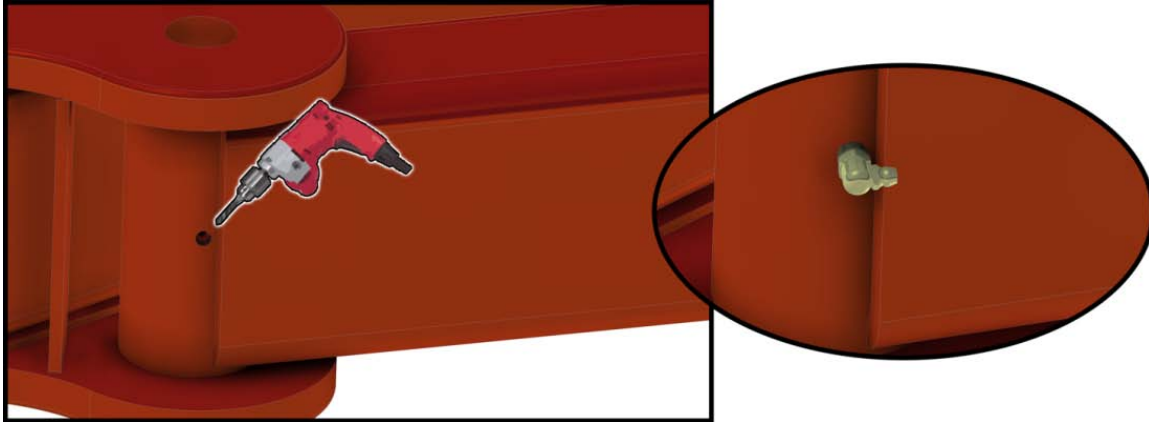

Figure 6 - Drill Tongue Pivot

img-00496

Step 7

Drill two (2) holes as shown below using a No. 7 (or 13/64") drill bit. Then use a 1/4"-20UNC tapping tool. Ensure that all metal shavings are thoroughly removed. Use provided template.

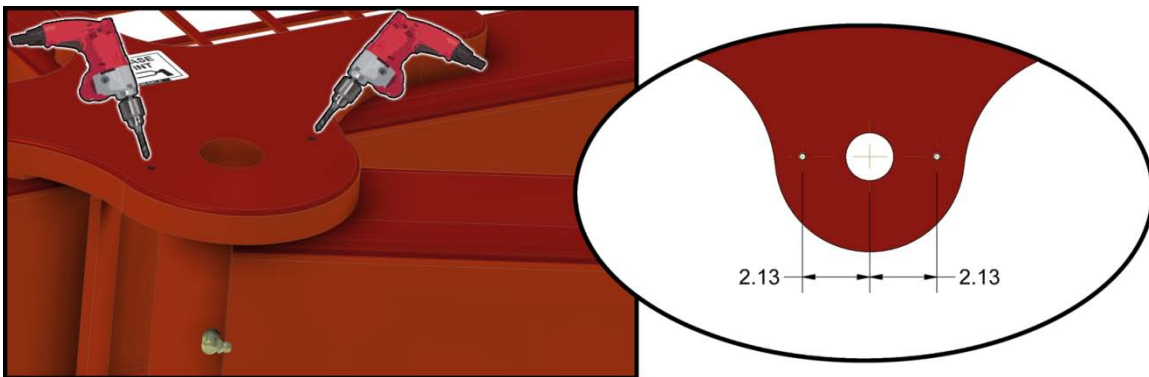

Figure 7 - Drill and Tap Holes

img-00497

Step 8

Install the tongue pin using the provided fasteners. Install the roll pin at the base once the pin has been installed. Using a grease gun lubricate the tongue pin.

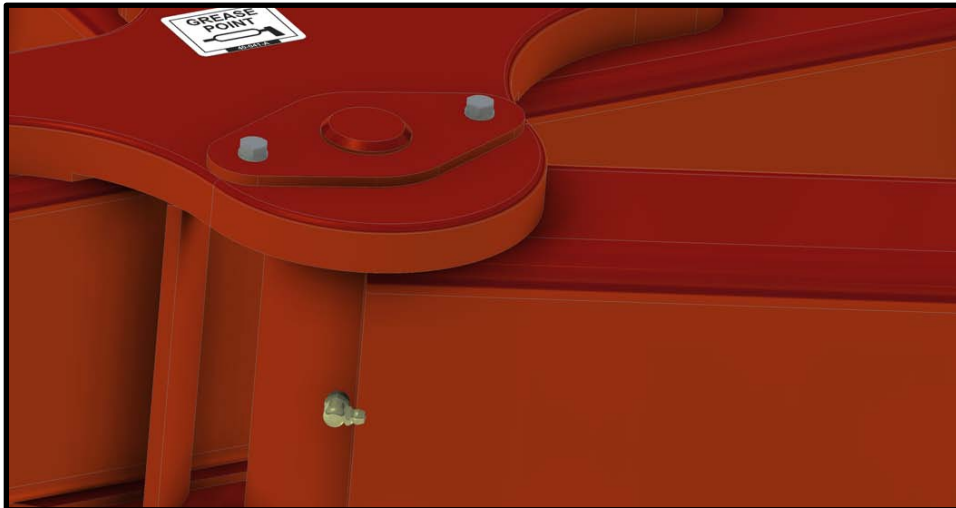

Figure 8 - Install Pin and Fasteners

img-00498

Step 9

Reconnect the cylinder pin to frame. Also reconnect the tongue brace.

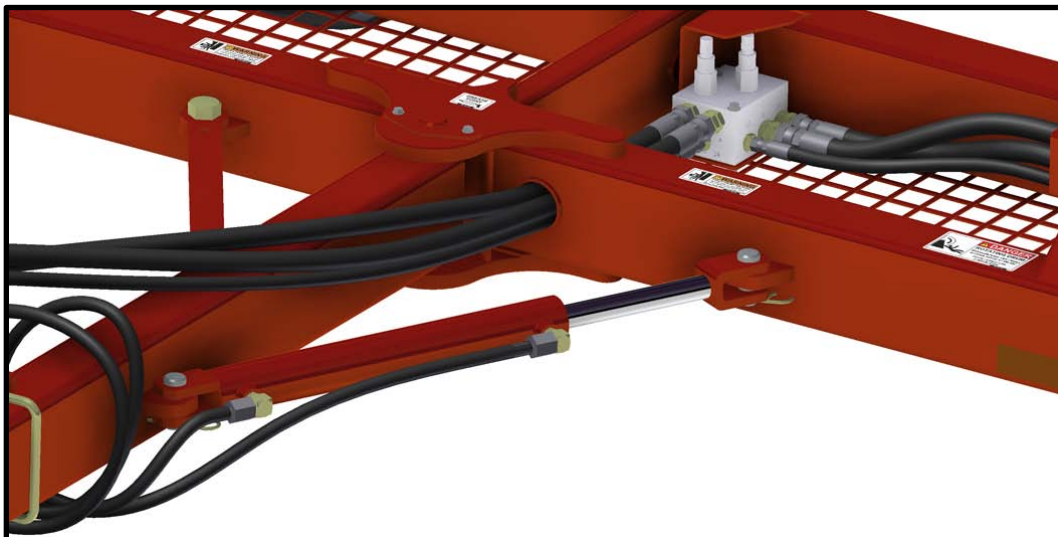

Figure 9 - Upgrade Complete

img-00499

Congratulations you have successfully completed the Tongue Pin upgrade.

Useful Information**LENGTH**

1 FOOT	= 12	Inches	1 METER	= 39.37	Inches
	= 0.3048	Meter		= 3.2808	Feet
1 ROD	= 198	Inches	1 MILE	= 5280	Feet
	= 16.5	Feet		= 1760	Yards
	= 5.5	Yards		= 320	Rods
	= 5.03	Meters		= 1609	Meters

AREA

1 SQUARE FOOT	= 144	Square Inches
	= 0.0929	Square Meters
1 SQUARE YARD	= 1296	Square Inches
	= 0.8361	Square Meters
1 SQUARE METER	= 1550	Square Inches
	= 10.764	Square Feet
1 ACRE	= 43560	Square Feet
	= 4047	Square Meters
	= 0.4047	Hectare
1 HECTARE	= 107639	Square Feet
	= 10000	Square Meters
	= 2.47105	Acres
1 SQUARE MILE	= 640	Acres
	= 259	Hectares

VOLUME

1 GALLON (US)	= 0.8327	Imperial Gallons
	= 231	Cubic Inches
	= 0.1337	Cubic Feet
	= 8.345	Pounds
1 CUBIC FOOT	= 1728	Cubic Inches
	= 7.48	Gallons (US)
	= 62.4	Pounds
	= 28.32	Liters
1 ACRE INCH	= 27154	Gallons (US)
	= 254	Cubic Meters / Hectare

AREA OF A CIRCLE = Diameter x Diameter x 0.7854

CYLINDER VOLUME (US GAL.) = Diameter (ft.) x Diameter (ft.) x Length (ft.) x 5.8748